

POWERSTATION 2015

Your First Choice for CAD/CAM Features and Value

POWERSTATION is a fully integrated 2-1/2 - 3 axis CAD/CAM system, utilizing an easy to use mouse / menu interface. Complete tutorials, documentation, and technical support make this affordable, proven software an outstanding value.

GEOMETRY

- ✓ The most powerful geometry creation capabilities of any CAD/CAM system available.
- ✓ Over 32 Point, 40 Line, 50 Arc Definition Methods !
- ✓ Ellipses, Rectangles, Polygons, Triangles
- ✓ Box's W/O Chamfers/Rounded Corners.
- ✓ Cubic, Bspline, Biezer curves, with optional "Arc-Fitting"
- ✓ Linear / Circular Slots
- ✓ Hole Patterns: Linear, Arc, Circle, Rectangle, Grid, Ellipse

CAD HIGHLIGHTS

- ✓ 256 Named Layers, 16 Colors, 10 Fonts (unlimited with pro-version)
- ✓ Storage for Unlimited Entities
- ✓ Geometric Tolerancing, Special Symbols, Grid, Snap
- ✓ Dimensional tolerances, limits, and Dual units
- ✓ Over 12 dimension types including, Base line, Ordinate, and Automatic
- ✓ Ten Trimming / Extending commands including "EASY-TRIM/EXTEND"
- ✓ Cross Hatching (10 styles) with islands
- ✓ Zoom / Pan
- ✓ Undo / Redo
- ✓ Leader / Section Lines
- ✓ Block Store / Retrieve

CAM HIGHLIGHTS

- ✓ Mills, Lathes, EDM's, (Punch/Burn with optional [POWER-FAB](#))
- ✓ Includes Post Processor Generator for Custom NC-code Output Dozens of Sample Posts Included
- ✓ Pocketing with Islands, w/multiple depths, feedrates, and auto clean-up
- ✓ Pockets: Free Form, Polygon, Circular
- ✓ Contouring W/O Tapered Walls
- ✓ Interactive Graphic Tool Path Editing / single block display
- ✓ Lathe: Rough Turn, Back-turn, Under-cut, Groove, Thread (Canned cycles too!), Drill, Chamfer
- ✓

- ✓ Operation / Tool List Printout, Store / Recall Standard Process Plan's
- ✓ Free Form Tool Motion: Drive the tool where & when you want it
- ✓ Text Engraving (PRO/PRO+ Includes

[WINGRAVER/WINGRAVER-PRO 2015](#) for True-Type Fonts)

- ✓ Over 30 Machining Cycles: Drilling, Boring, Tapping, Chain Cutting, lead in/out, circle clean-up, helical, optimized drill paths, multiple parts, thread milling, to name a few !
- ✓ **POWERSURF** - Advanced 3D Surfacing Module, for Creating Surfaces: Ruled, Revolved, Coons Patch, Skinned / Lofted, Radial, Included at no charge !!

- ✓ **DXF Import / Export** Capability - Bring in drawings made with AutoCAD (Includes AutoCAD 2017), Cadkey, PRO-E, Solidworks, Design Cad, Intellicad, any any other fully DXF compatible CAD or CAM system.
- ✓ MINI-CAM, HPGL Import
- ✓ IGES Import (PRO/PRO+)/Export
- ✓ **Large, Complete, Printed Manuals !!!**
- ✓ Complete Post Customizing with Post Macros
- ✓ Includes Library of Sample Post processors
- ✓ NO Hardware Lock protection required

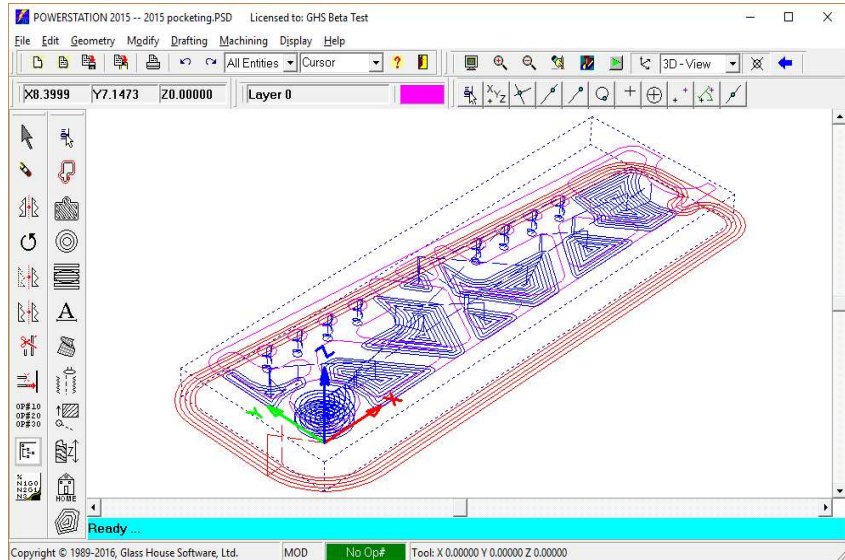

CAD/CAM DESKTOP

True NC-Code Editor

- ✓ Edit Large Multi-Megabyte files quickly
- ✓ Resequence Block Numbers
- ✓ Remove Sequence Numbers
- ✓ Find and Replace
- ✓ Insert Special Characters
- ✓ File Compare - Spots differences between edited version of the same program
- ✓ DNC Communications - Includes on-line documentation on proven setups for many common controls
- ✓ Machine Setup -- Allows complete customization of the generated NC-Code (See [NC-Code](#) below)
- ✓ NC-Code file "Pretty Printing" for easier to read NC-Code listings
- ✓ Triangle Solver
- ✓ File utilities to simplify copy to/from diskette, system setting backups, etc..

- ✓ "Basic-Like" macro language for custom routines. Extend / Customize POWERSTATION for any of your special requirements. Easily build parametric programs.

Download a FREE Demo
WWW.MICROCIMM.COM

EASY TO USE

If a system is powerful but its power cannot be tapped, it is useless. If a system is simple to use, but its power limited, your business can suffer. Ease of use is an often abused term in the computer industry today. Included with every system are full self teaching step by step tutorials and a detailed help reference.

SYSTEM HIGHLIGHTS

WWW.MICROCIMM.COM

WORK AT YOUR LEVEL

Commands can be entered by simple mouse - menu selection or by shortcut keyboard commands. These two methods can be freely intermixed, providing an optimum user interface tailored to the way that you think and work. For example: in many cases you will be asked to indicate with the cursor the approximate location of a blend radius or tool position. The system will take this location and calculate the exact position automatically.

Shop people are machinists and mechanics not computer programmers. Shop people want to get in, create a good, verified program and get back to the business of doing what they do best; making parts.

On-line, hypertext help is always a keystroke away. You simply point and click on the topic in question. The system will give information on the topic and automatically display related topics.

All prompts are written in simple shop English not computerese. Practical defaults to all questions speed job creation.

NC-CODE GENERATION (POST-PROCESSING)

An extensive library of over 90 pre-written post processors is supplied on your system CD-ROM at no additional charge. Use these posts as is, or customize them to meet your specific needs.

Included in POWERSTATION is a generalized post processor that provides the ability to "teach" the system attributes of each of your current and future machines.

By answering simple questions pertaining to : G & M codes, number formats, etc., the generalized post automatically creates and maintains a parameter file for that specific machine.

Once created, these files are automatically retrieved and used by simply specifying the machines name.

Post macros: The post macro feature allows for simple customization of the post processor output. Basically an operator defines a post macro by painting a picture of the desired output and assigning a name to this information. Unlike many systems where this information is static and unchanging, POWERSTATION post macros are dynamic and can make logical decisions based on the current machine status.

This flexible system has been customer tailored to a broad range of NC/CNC machine tools, from old hard wired NC-chucker lathes to modern multi-axis CNC machining centers.

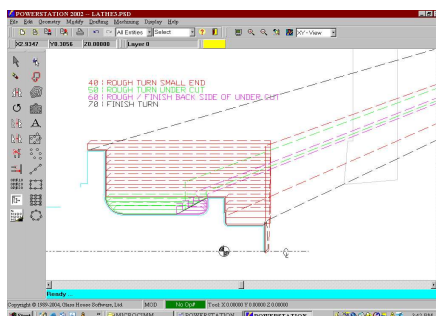

ASSOCIATIVITY

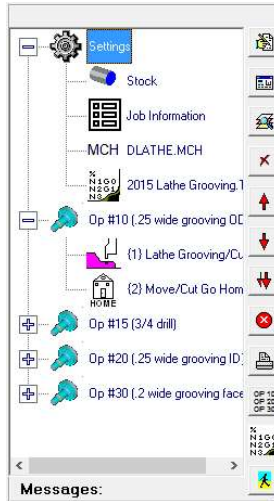

"ASSOCIATIVITY" HAS ONLY BEEN AVAILABLE IN CAD/CAM PROGRAMMING SYSTEMS COSTING OVER \$8,000

NOT ANYMORE !!!

Now, When You Need To Change Your Tooling, Part Geometry, Or Any Other Engineering Revision Is Called For....

POWERSTATION - 2015 With Full "Associativity" Can Automatically Re-Generate All Your Toolpaths... Easily, Quickly, and Affordably.

Increases Your Programming Productivity:

Break An End Mill ?
Tool Chattering ?
Bad - Inaccurate Print ?
Last Minute Engineering Change ?

No Problem, With POWERSTATION'S "ASSOCIATIVITY" Change the Geometry, Tooling, Stock Allowance, Feed, Cut Depth, Etc..., Press a Single Button, and Let POWERSTATION - 2015 Automatically, And Quickly, Re-Generate The Toolpaths.

You Will Have your Machine Back Up and Running in Minutes, Not Hours !!!

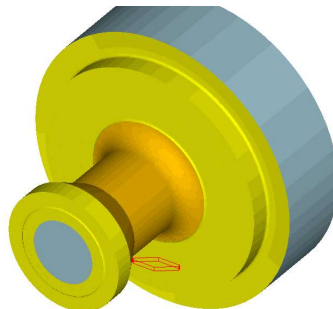

Options: Pro Version Includes:

Ask-Sal! – Extensive Tool & Material Library. Comes pre-loaded with hundreds of common Tools & Materials. Full integration with POWERSTATION.

NC-Code Analyzer – Checks for accuracy and graphically verifies you -G- Code programs no matter if they were generated with POWERSTATION or manually. Includes an accurate cycle time estimation.

WINGRAVER – True Type font engraving program. Includes many styles, patterns of text, and 10 custom machinable "stick" fonts.

Pro + Version (Includes all the Features of PRO Plus)

Wingraver Pro 2015 – All of the features of WINGRAVER plus, built in raster to vector conversion for use with scanned pictures. Automatic generation of raised or inset letters.

Quick-Link 2013 – High end NC-Code editing and advanced DNC. Re-format, adjust registers, feeds, speeds, compare edited files, and much more.

Minimum System Requirements

- ✓ Windows XP/Vista/7/8/10 32/64 Bit
- ✓ 1 Gb XP, 4 GB all others
- ✓ 55MB Free hard drive space
- ✓ 1024 X 768 Resolution Minimum
- ✓ CD-ROM Drive

Call Today for Information

For more information on how POWERSTATION can give you BIG SHOP power and still be the most affordable CAD/CAM Value on the market today, please contact your authorized distributor.

WWW.MICROCIMM.COM

Authorized Distributor

WWW.MICROCIMM.COM